

FILTRATION EQUIPMENT

Reverse Flushers Code 2166

Conflow is renowned the world over as the leading supplier of specialist components and systems for dust suppression, fire suppression and all aspects of water control in underground coal Mining.

Today Conflow products can be found operating both on the surface and underground in all the major mining industries, from coal to gold, in more than 30 countries around the world. Furthermore, wherever minerals are moved in bulk – such as quarries, power stations and steel works - Conflow products are helping to reduce the negative impact on the local environment.

At Conflow our aim is to provide you with a comprehensive range of services to meet your individual needs.



Description

The **Conflow Code 2166** - Reverse Flushing Strainer has been designed to provide filtration in water feed lines. The simple, positive action changeover valve provides reverse flushing to clear the main strainer screens without the flowline having to be shut off or the filter element removed.

Due to the design of the main strainer screen the pressure drop across the unit is exceptionally low.

Typical Applications

- To clean water being supplied to belt line dust suppression systems.
- Cleaning water supplies to longwall faces and continuous miners

Features

- 1" & 1 1/4" sizes available
- Maximum working pressure for sizes up to 1 1/4", 105 bar
- Reverse flushing without the need for line shut-off or element removal
- Exceptionally low pressure drop
- Simple positive action

FILTRATION EQUIPMENT

Reverse Flushers

Code 2166

Specifications

Dimension	Unit	1"	1 1/4"
A	mm	356	425
B	mm	172	218
C	mm	169	215
D	mm	390	470
WEIGHT	Kg	17	30

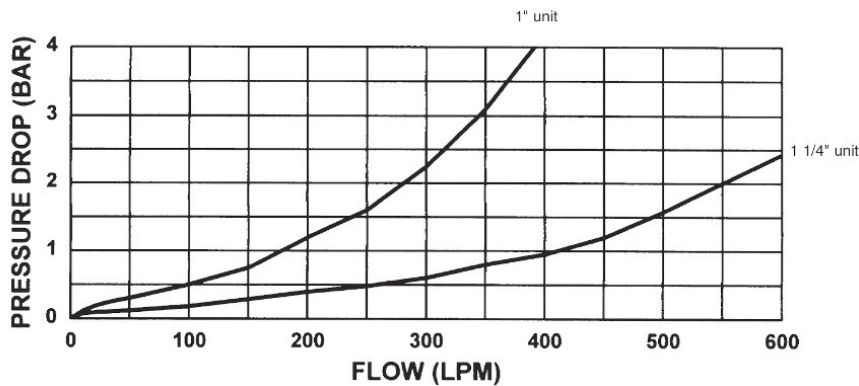
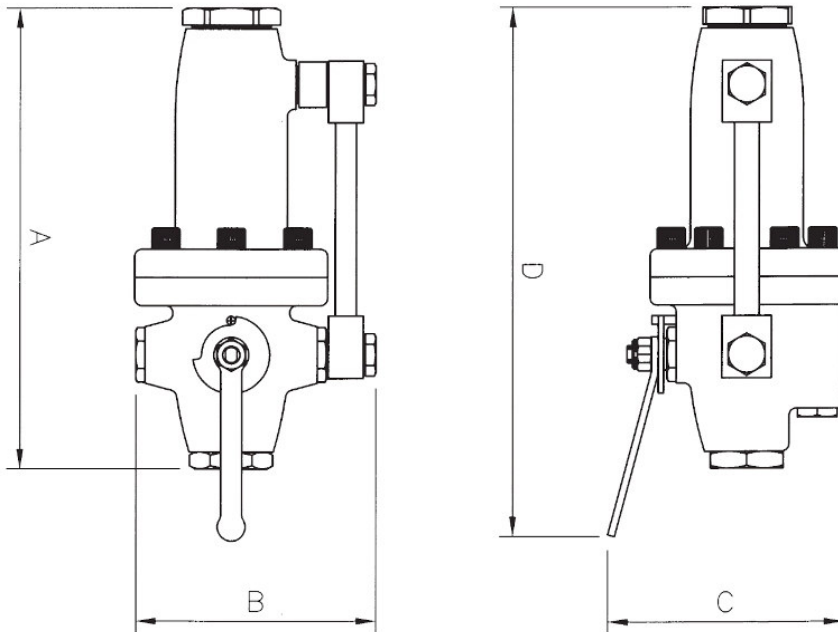

The information on this data sheet is accurate to the best of Conflow's knowledge, however we reserve the right to alter the product specification at any time. For any specific updated detail, please contact us.